

A Survey

of the entire Parish of Hempstead in
Essex and of all the Estates of
William Harvey Esq^r. therein, and
in the Parishes adjoining thereto, laid out in
separate and distinct Farms and Holdings, as
they are now Occupied, and made to agree with
the General Maps of Survey by References
to the Letters and Numbers therein, showing the
Plans and Contents of each
taken in the Year 1770
by Owen Swan.

Mercers Hall Demons

The map letter

I

Little flow beds passing to the flow field, weathering about 4-6-0
does not appear in this shape -

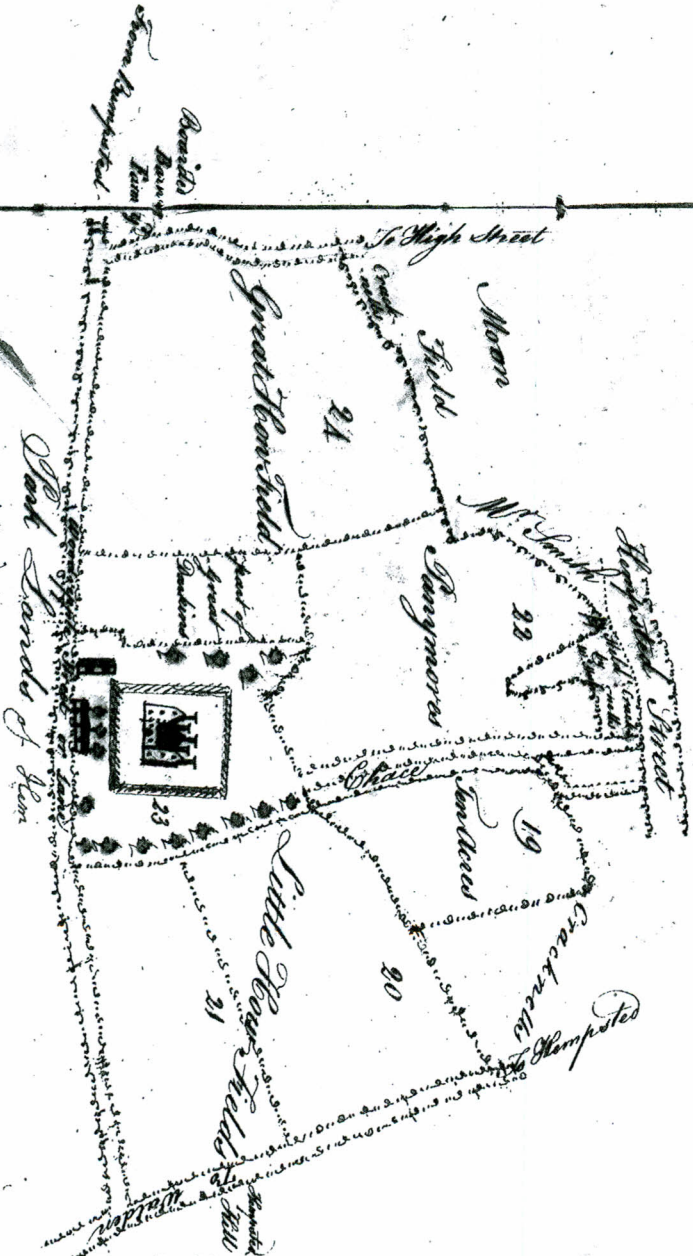

(71)

Church Farm in the tenure of Thomas Horner
with thirty acres added to the parcel of Euphy-
bro Acres held by Thomas Horner of Kemmes Hill 1716

Map I

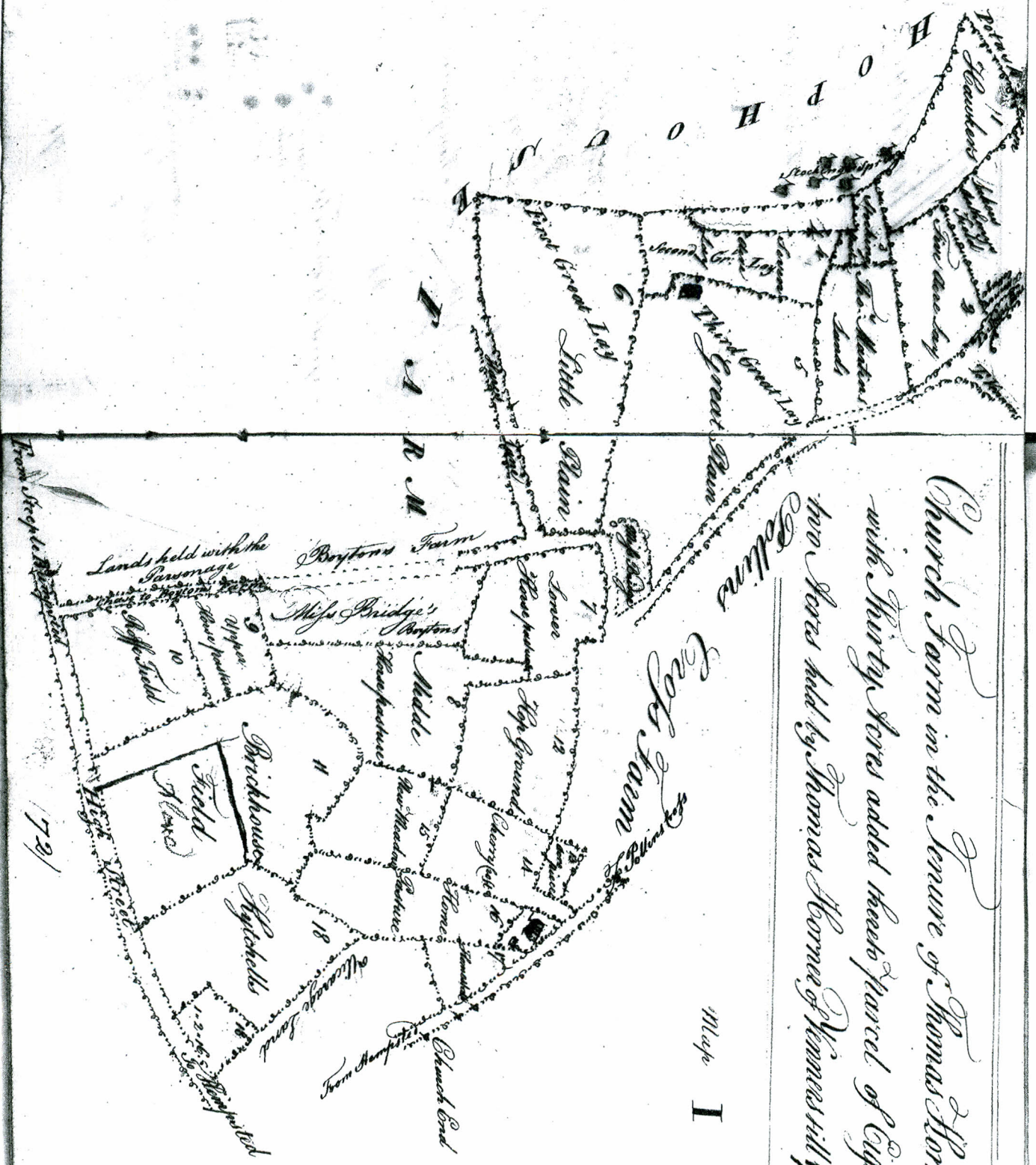

1721

Bulls Bridge Farm
with Lee fields & Barnells land
on the house of Robert Cook

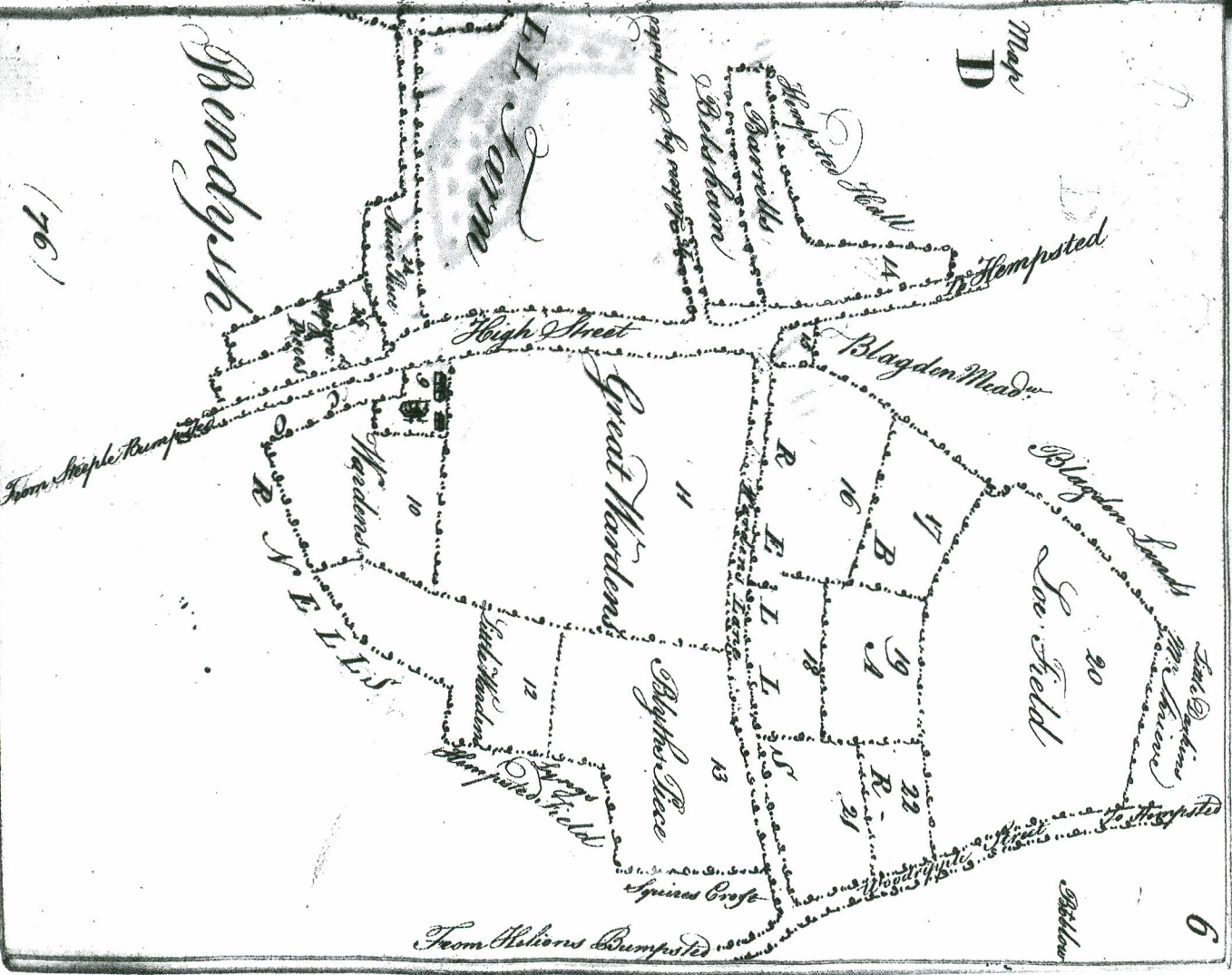
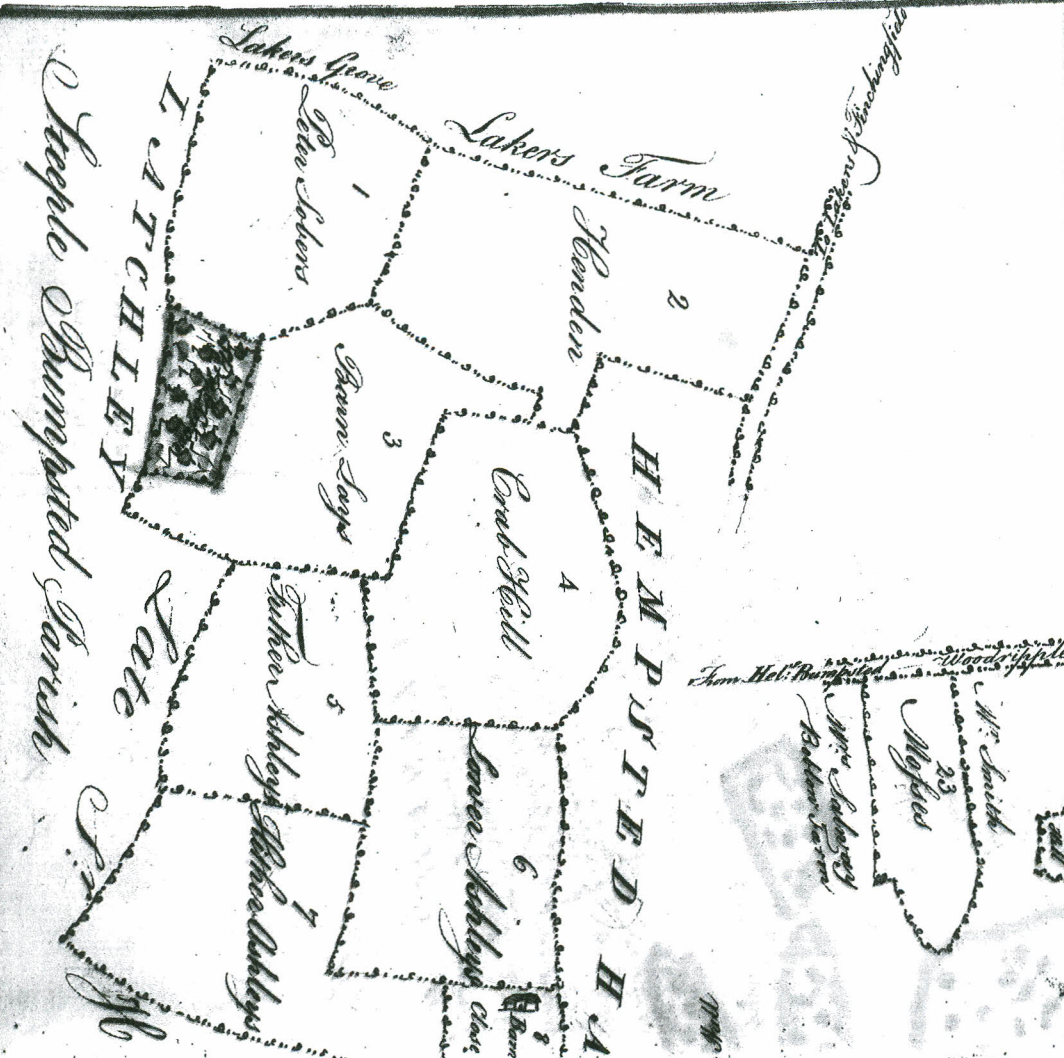

(76)

Lands held by Martin Willis containing by
 Estimation 26 ^{acres} parcel of 82 Acres formerly held
 by Tho: Horner of Hemmers

Map
 F

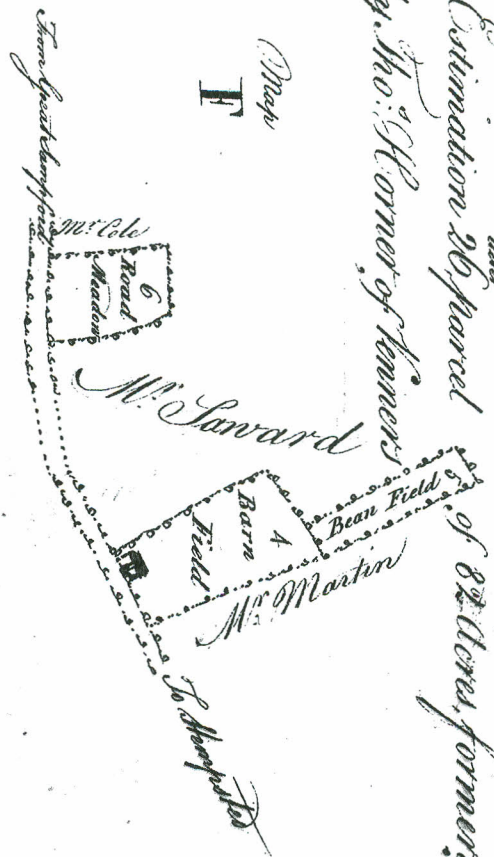

(79)

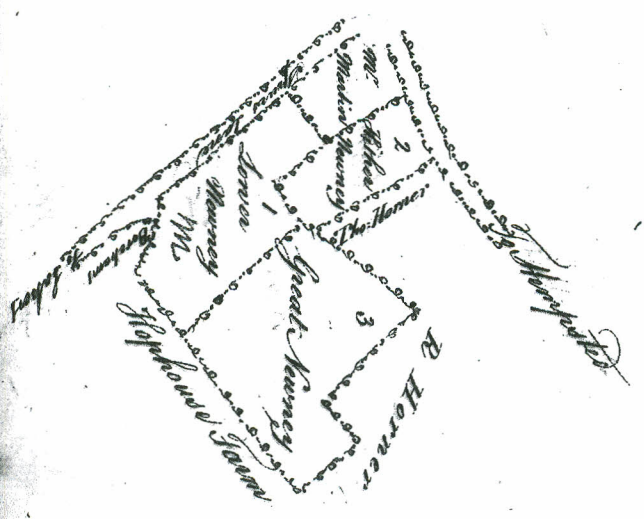

A Cottage and Lands in Hemsted in
 tenure of the W^m: Boreham with Swanfield late
 held by Sampson formerly part of Tho: Horner's 82^{ac}

Map
 G

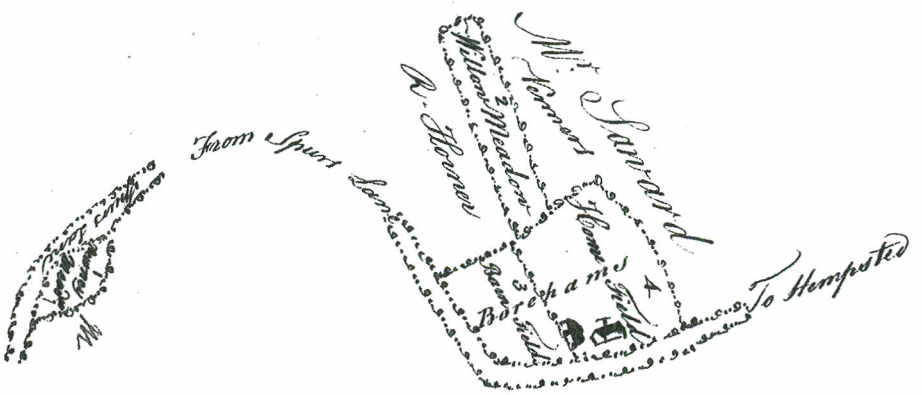

(79)

The Manor Farm & Decemars of Free Roberts
 Hempsted Parish in the
 Land containing 1. 1. 20

Map
 P

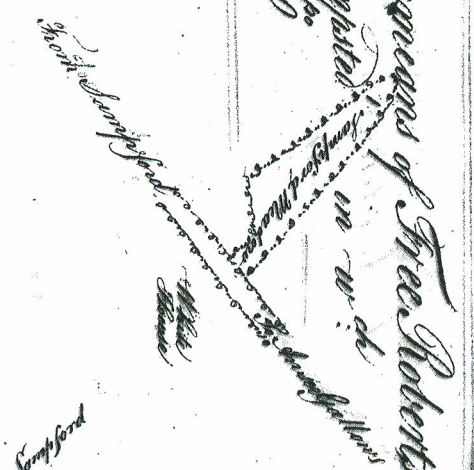

in Great Sampford together with lands call'd
 is included a piece of Hempsted Rectory

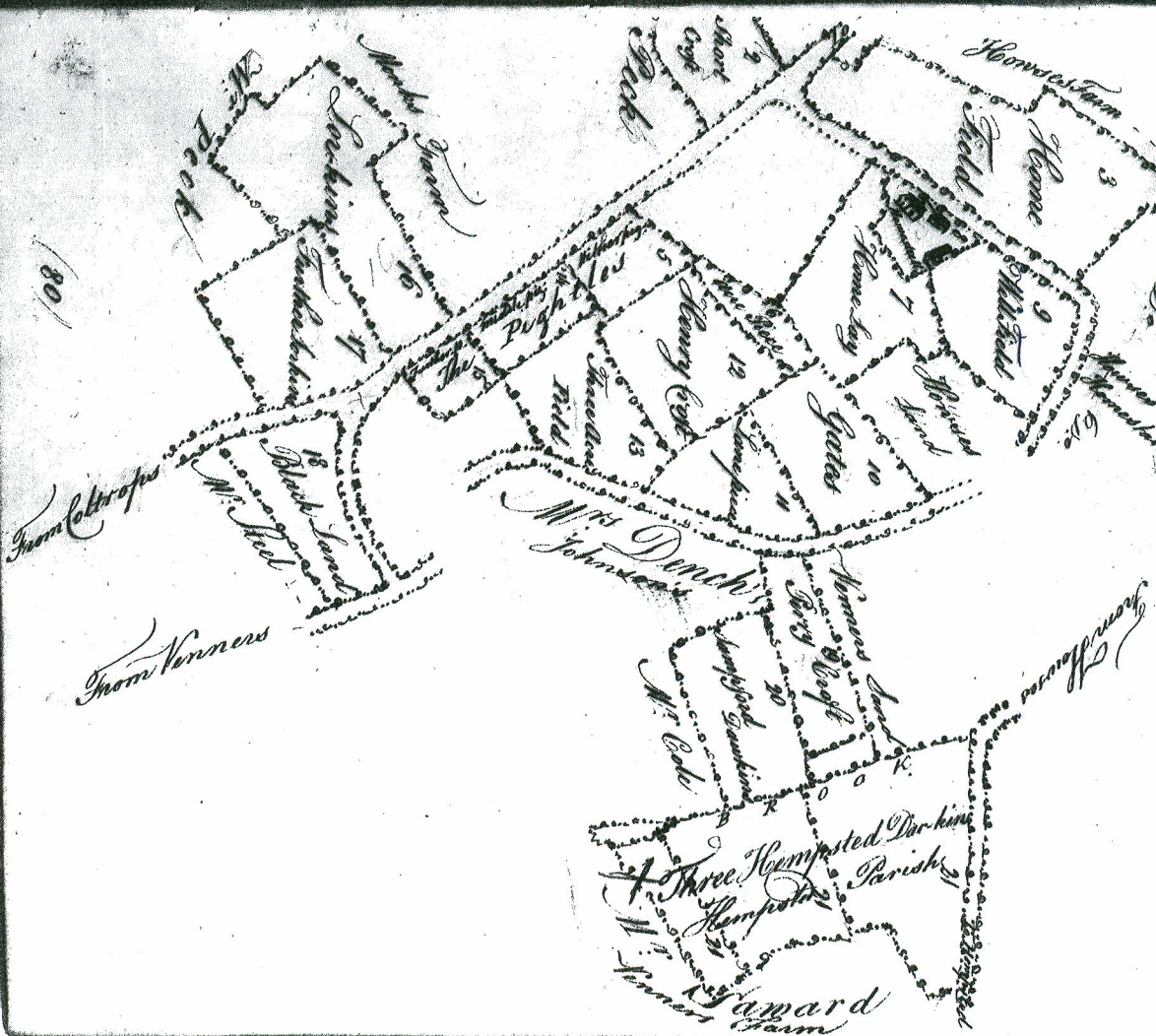

1801